

CAMILLE PARK MASTER PLAN

TUALATIN HILLS PARK AND RECREATION DISTRICT

2006/2007

department of planning + development
department of natural resources



CAMILLE PARK MASTER PLAN

TUALATIN HILLS PARK AND RECREATION DISTRICT

2006/2007

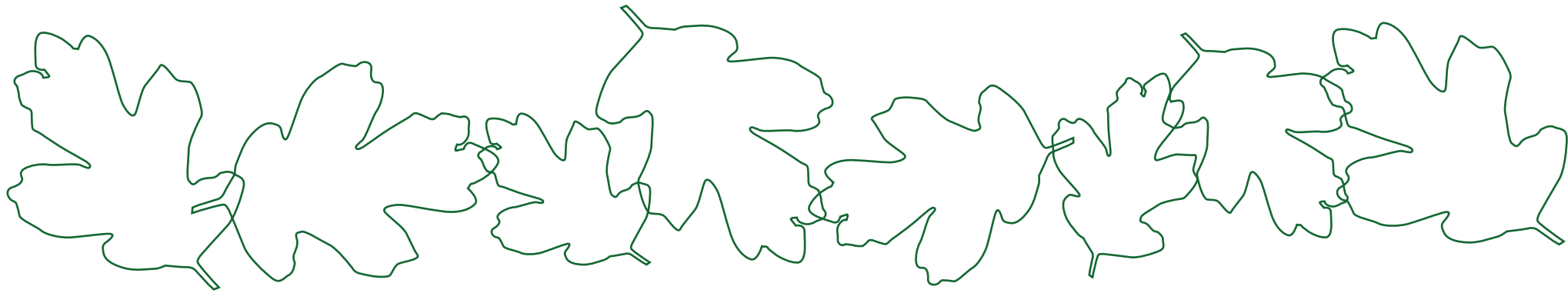

ACKNOWLEDGEMENTS

Tualatin Hills Park & Recreation District Board of Directors

John Griffiths, President / Director

Larry Pelatt, Secretary / Director

William Kanable, Secretary Pro-Tempore / Director

Joseph Blowers, Director

Bob Scott, Director

Tualatin Hills Park & Recreation District Staff

Bruce Barbarasch, Natural Resources Supervisor

April Cottini, Park Planner

Julie Reilly, Natural Resources Specialist



TABLE OF CONTENTS

Introduction.....	1
Executive Summary.....	2
Site Description.....	4
The Planning Process.....	7
The Master Plan.....	15
Appendix 1 Public Involvement.....	20
Appendix 2 Natural Resources Management Details.....	31

INTRODUCTION

PURPOSE OF A MASTER PLAN

The Camille Park Master Plan provides the 12-acre site with a long-term guide for public access, amenity development, and natural resource protection and enhancement. The Master Plan identifies overall goals and objectives for the site, accompanied by several supporting concepts that will be refined and fully developed over time.

The plan will provide the neighborhood and community with the following benefits:

- Safe, accessible passive recreation opportunities.
- Protection and enhancement of native vegetation.
- Enhanced picnic and active recreation facilities.
- Environmental education opportunities.
- An increased awareness and appreciation for the region's natural history.

SITE HISTORY

Camille Park was acquired in 1961, shortly after the development of the surrounding neighborhood. The park was in a topographically low spot and supported wetlands and seasonally flooded areas. When the park was developed, native vegetation and “brush” were removed, parts of the park were graded, and a path and other recreation amenities including a playground and tennis courts were added over the years. Although the park was modified for active recreation, many of the natural aspects of the property remained. A significant stand of Oregon white oak trees as well as camas wildflowers continued to persist in the park as well as a fringe area of wetland forest.

The park has historically been a very wet area and records document many complaints or complications about water issues in the park, which may have affected the neighborhood. A man-made drainage ditch/stream crosses the northern area of the park. Water flows through this stream from the east and drains towards Highway 217 in the west. The grade in the stream is very flat, so water moves through it slowly. In 2005 City of Beaverton completed a major upgrade to the stormwater system in the Heather Lane area of the

neighborhood where stormwater pipes daylight at the aforementioned stream. The area around the stream was revegetated in winter 2007 to improve aesthetics, water quality, and wildlife habitat.

As a result of neighborhood inquiries, an interest in protecting the park's camas and oak areas, and interest from community partners, Park District staff requested and received management approval to create a master plan for the park in 2006.



EXECUTIVE SUMMARY

MASTER PLAN GOALS

The goals of the Master Plan provided the foundation for the planning efforts. The project goals were derived from the Park District's Comprehensive Plan, Natural Resources Management Plan, and Sustainable Practices Program, as well as from Patron concerns and interests. The Master Plan aims to highlight the park's natural features while fostering traditional recreation activities in appropriate areas. The goals are as follows:

Recreation

- Provide opportunities for self-directed active recreation activities via existing tennis courts.
- Foster passive recreation such as picnicking, walking, jogging, and wildlife watching through loop trail and viewing areas.
- Use environmentally friendly materials in construction or improvement of the parks built resources.

Environmental Education

- Develop an interpretive sign system that helps Patrons understand the park's ecological systems and natural history.
- Create a playground area that allows children to learn about nature through tactile and physical activities.

Public Access

- Develop a trail network that fosters observation, to connect to neighborhood context, and enjoyment of the park's natural areas, while protecting fragile resources.
- Create seating or other quiet areas that allow contemplation and enjoyment of the parks' natural features.
- Provide for safe use of the park. Maintain visibility along paths and structures for safety.

Habitat Conservation, Restoration, and Enhancement

- Move and/or locate new recreational amenities in locations that protect natural resources.
- Protect, restore, and expand native plant communities and wildlife populations found in the park. Camas wildflowers and

Oregon white oak trees are the primary conservation targets. Remove invasive species.

- Expand specific natural areas into wet areas of park where they were historically found.

Water Management

- Provide drainage of neighborhood stormwater via existing stream in northern portion of park.
- Improve water quality through vegetative shading of stream and wetlands.
- Minimize use of impervious surfaces. Where hard surfaces are necessary consider alternatives such as pervious pavement or boardwalk materials.



KEY ELEMENTS OF THE APPROVED MASTER PLAN

The publicly preferred and approved Master Plan aims to turn Camille Park into a “Nature Place” where Patrons can be immersed in the park’s natural features while enjoying the more active recreational amenities of a developed park. The plan takes advantage of the site’s topography by highlighting the natural features like the trees and wetlands, while locating recreational amenities in higher, less sensitive, and more accessible areas. Key changes to the park include:

1. Expansion and enhancement of natural areas.

The park has a wealth of unique native plant communities such as a camas wildflower meadow with a canopy of Oregon white oaks. These areas will receive an increased level of care. Additional wet areas that are currently maintained as turf will be returned to more natural wetland areas.

2. Consolidation of picnic areas and addition of shelter.

In order to provide a higher level of service, to protect Oregon white oak trees, and reduce conflicts with neighbors, the current picnic areas will be consolidated in the southeast corner of the park. A shelter will expand the usable season for the picnic area and potentially provide rental revenue for maintenance upkeep.

3. Removal of the basketball court.

The current basketball court is at the bottom of a slope. Water and sediment run across it for much of the year, making the court difficult to use and a challenge to maintain. Because there is not a suitable location for it in the park, when the basketball court wears out, it will be removed to protect natural resources. Park District energies used to maintain the court will be re-invested elsewhere in the park. Several sets of covered basketball courts are located at adjacent school properties and are open to the public when school is not in session.

4. Installation of a loop trail.

Adding additional hard surface trails in the park to make a loop trail will benefit Patrons’ strong interest in walking in the park throughout the year. The trail will also protect existing habitat areas of the park by keeping Patrons from trampling fragile resources. In addition,

discussions about extending soft surface trails out of the park will be held with neighboring property owners.

DESCRIPTION OF OVERALL COSTS

The proposed improvements to the park included in this master plan are estimated to cost \$507,000. Changes are expected to be implemented in phases over time, as funds are available. Each phase will require the development of more detailed design work to determine needs and actual costs. Therefore these estimates are preliminary, but provide an insight into the costs relative to the design. Cost estimates are made in 2007 dollars.

- Trail Phase: \$207,000
- Play equipment/area: \$144,000
- Signage: \$24,000
- Habitat enhancement areas: \$24,000
- Picnic shelter & site improvements: \$108,000

Detailed information on project costs can be found on page 19.



SITE DESCRIPTION

PARK TYPE

The Park District's Comprehensive Plan has designated Camille Park as a Community Park. A Community Park is a larger park that provides active and passive recreational opportunities for all Park District residents within a three-mile radius of neighborhoods around it. They may accommodate large group activities, including facilities for organized recreation activities and on-site parking.

NEIGHBORHOOD CONTEXT

Camille Park is surrounded on two sides by a low-density residential neighborhood and on the other sides by a middle school and wetland forests that are both publicly and privately owned. A four-lane highway is a few hundred feet west of the park and can be heard by park Patrons. There are three Park District maintained access points to the park and several unofficial entrances from the forest south of the park. Access to the middle school grounds can be made through the southeast corner of the park.

EXISTING FACILITIES AND TRAILS

Camille Park currently provides passive recreation opportunities such as picnicking, walking and bird watching, as well as facilities for active pursuits including tennis courts, a basketball court, and play equipment. Because the basketball court is in a low, wet location, water and sediment often make it unusable. A paved trail cuts diagonally across the park. It is accessible year round, although water sometimes flows across it. Many walkers and students on their way to school use the trail. Much of the un-paved area of the park is inaccessible during the rainy season due to high water levels.

Amenities include a basketball court, four fenced tennis courts, horseshoe pits, a play structure, and swing set. Picnic tables are grouped in several places in the park, and there are two raised barbecue stands. A 1,830-foot long paved walking path runs through the center of the park from north to south, providing access from surrounding areas. A small parking lot with 10 parking spaces is located off SW Marjorie Lane. The park is heavily used by the neighborhood for strolling and picnics; children often ride bikes on the path and play near the stream. The Denney-Whitford

Neighborhood Association is very interested in how the park is maintained and used. They have been an advocate for park improvements and have made offers to help fundraise for improvements.

NATURAL RESOURCES

Although parts of Camille Park have been graded, grubbed, and ditched, significant natural resources still exist on the site. In fact, the District's Natural Resources Management Plan ranks Camille Park as one of the Park District's top twenty priority sites.

The park is part of the Fanno Creek watershed and has an unnamed tributary stream that drains into it. Camille Park is at the bottom of a watershed sub-basin, hence it receives a considerable amount of water. The water supports wetland habitats which include mixed Oregon ash – Oregon white oak forest (classified as palustrine forest) and uncommon herbaceous plants including camas and Indian hellebore.

Much of the site is classified as wetland, although not all areas of the park have been maintained as such. The park has heavy clay soils that retain standing water from winter through spring, and sometimes into early summer. These areas usually remain too soggy to mow until well into April. The west side of the park contains a dense population of great camas lily, *Camassia leichtlinii*, which are wetland plants with several bright blue flowers on each stalk. These areas are designated as a camas preservation site, and are not mowed from March until the camas seeds are ripe and drop from the plants, usually in early to mid-July. As habitat has been developed or farmed, camas has become increasingly rare across its historic range in the Willamette Valley.

Beyond the camas preservation area, the west side of the park consists of a narrow strip of natural area containing many native shrubs and a variety of native ground covers. This strip is currently not maintained, and is the only non-maintained area in the park. It is difficult to distinguish the park boundary here since undisturbed forested areas with a native shrub understory are on neighboring properties. A small stream lies in a gully that runs east to west near



the north side of the park, providing drainage for city stormwater and habitat for small animals.

The rest of Camille Park consists of Oregon white oak (*Quercus garryana*) and Oregon ash (*Fraxinus latifolia*) trees although it is highly managed and regularly mowed underneath. There are no understory shrubs, and the herbaceous layer is essentially turf and low-growing weedy species. In the camas preserve area, the herbaceous layer consists mostly of camas lily.

Currently, no areas of Camille Park have restricted access and few places remain undisturbed. The natural resource value of Camille lies first in the canopy of Oregon white oak trees, and second in the wetland habitat in the southern half and western edge of the park. Oregon white oak trees are a conservation target in the Willamette Valley and throughout the Pacific Northwest. Due to an absence of natural processes such as wildfire, mature oak trees in the Park are threatened to be shaded and out-competed by faster growing Oregon ash. The Natural Resources Maintenance-Management Plan for Camille Park calls for ash to be selectively removed to maintain the Oregon white oak community.

NATURAL RESOURCES MAINTENANCE-MANAGEMENT PLAN

A natural resources inventory and wetland determination of Camille Park has been completed. Based on the information gathered, a Natural Resources Maintenance-Management Plan (MMP) has been created. The intention of the plan is to provide a vision and guidelines for maintaining and improving the ecological health of Camille Park in the short and long term. Its recommendations are integrated in the Park's Master Plan. There are several site challenges mentioned in the MMP that should be considered as development activities occur in the park:

Wetland Areas

- Although parts of the park appear to be developed, much of it is a legally delineated wetland. Therefore, the siting of new amenities including trails will need to be carefully considered. In some cases, wetland mitigation may be required to compensate for impacts. If this is the case, areas within the park (such as the proposed enhanced meadow/wetland in the NE corner) should be

considered as possible on-site mitigation sites well in advance of construction.

- Drainage on the site has long been an issue. Creating new drainage (French drains, drain tiles, etc.) could dewater or inundate existing wetlands.

Oregon White Oaks

- Although oak trees are long lived, they are sensitive to root damage. Development and construction activities should take place outside of oak root zones. Recreation activity should also be planned outside of the root zones of existing trees.
- Under natural circumstances, oaks do not receive much water during the summer. Oaks should not be irrigated during the summer months; manipulation of irrigation in lawn and active space areas should be considered.

Stream Buffer

- The drainage running through the NW section of the park is considered a perennial stream by Clean Water Services' definition. The stream feeds directly into Fanno Creek (a salmon bearing stream).
- A fifty foot vegetated buffer is required on either side of the stream. The buffer provides shade, which keeps the water cool for salmon and other forms of aquatic life.
- Periodic channel work by the City of Beaverton may be required to meet their drainage requirements. Future access for large equipment in the area should be considered as trails and other site enhancements are installed.





THE PLANNING PROCESS

OVERVIEW OF WORKSHOPS AND PRESENTATIONS

Because Camille Park is a well established and much used park, acquiring input from its users and nearby residents was crucial to the development of a master plan. Public input was sought through a combination of mailers, surveys, Public Notices in newspapers, flyers, and via the THPRD website.

An initial Patron survey was sent out to 400 Patrons near the park. The survey was also publicized in the park and THPRD facilities, as well as through the media and local Neighborhood Action Committees. Patrons had the option of filling out the survey on-line or on paper. Fifty-six complete surveys were received as well as a number of individual comments. An initial Public Meeting was held to solicit further discussion on the survey results and park. These comments were used to create several options for further Patron comments.

Three options were developed and additional comments were sought via a mailing of 800 postcards to addresses throughout the park's service area. In addition, posters and comment forms were displayed at the three nearest THPRD recreation centers, similar materials were posted on the THPRD internet site, and a Public Meeting was conducted to decide which option to develop into a final plan.

Public presentations and THPRD Board of Directors presentations were held to discuss the plan as follows:

Scoping Public Meeting	7/26/2006
Concept Public Meeting	9/7/2006
Final public open house	11/2/2006
Board of Directors presentation & approval	3/2007

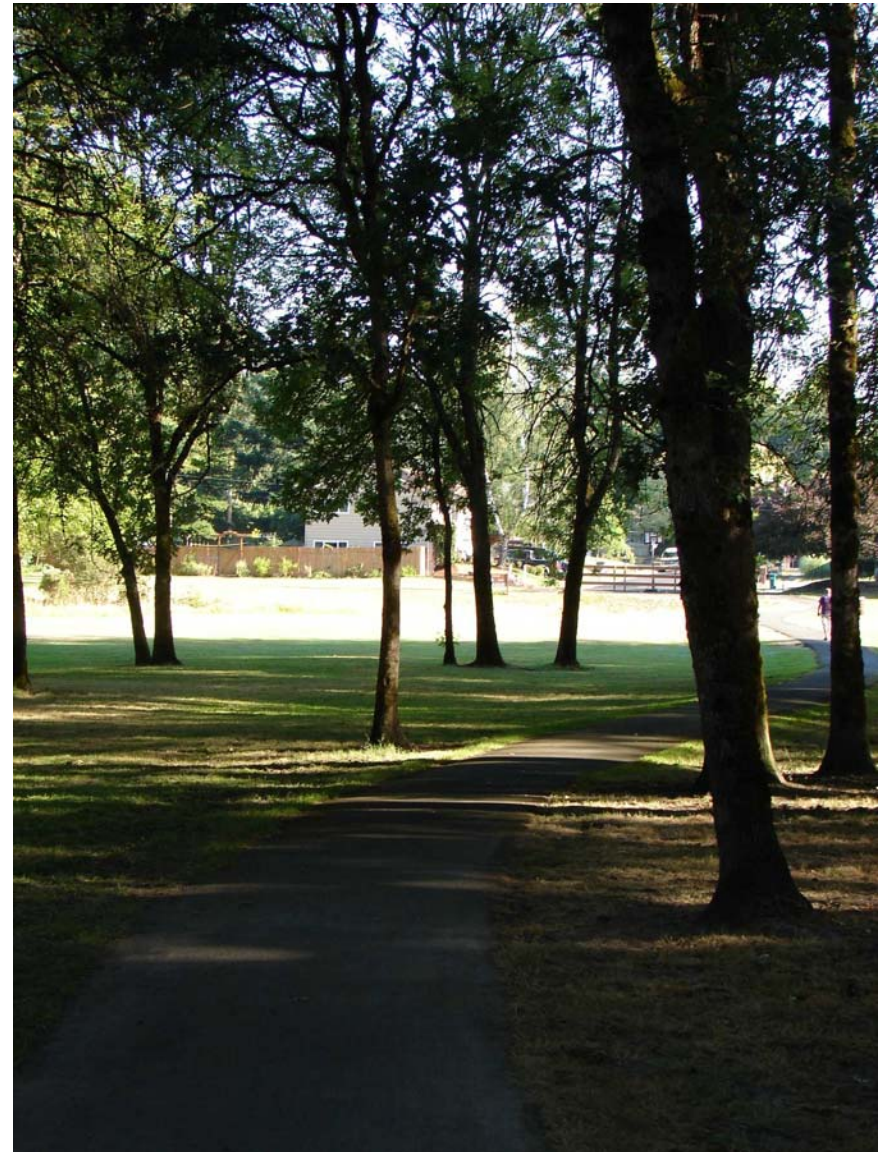

DEVELOPMENT OF OPTIONS

The initial survey responses showed high rankings for the walking path and trees as Patron's favorite amenities, followed by the play structure. Patrons expressed a strong appreciation for the quiet, shaded aspects of the park. A vast majority of respondents ranked Camille as a high or medium value natural resource area and many comments indicated a desire to see an enhancement and/or expansion of the park's natural area. A number of comments also supported basketball or tennis facilities in the Park. Based on Patron input, existing THPRD plans, and staff input, three options were developed for further study. The options represent a continuum from maintaining the park in its current state to shifting the management to emphasize its natural resources.

Option I: Base Case

This option suggested an increase in maintenance and basic site improvements (ADA access, playground upgrade, tree pruning work) but did not significantly change the activities or nature of the park. It suggested the construction of a simple loop trail to improve site access and "walkability" of the site.

Option II: Moderate Natural Resource-Focused Improvements

Option II retained the elements of Option I, but also sought to establish a meadow landscape in some of the current mowed wetland areas. It also suggested reconfiguring the play and picnic areas for lesser-environmental impact and increased educational opportunities, as well as installing a covered picnic structure. This option would incorporate sustainable "green" building materials in future enhancements.

Option III: A Nature Place

The goal of Option III was to create a nature-focused park with a strong educational component to inform park Patrons about the natural resources and ecologies of the site/area. This plan incorporates the elements of Options I and II, but calls for the removal of the basketball court. It places a higher emphasis on fostering new natural areas, and enhancing the existing camas preserve and Oregon oak population. It would also introduce park wayfinding and interpretive signage, a "nature walk" segment with interpretive graphics, and a nature themed playground and exploratory area.

Conclusions

Twenty-eight final comments about the options were received. Patrons preferred option III (A Nature Place) by a ratio of nearly 2 to 1 (see Chart 1). Option three was further developed and presented at a Public Meeting with three Patrons attending. Patrons liked the plan and no suggestions or changes were made.

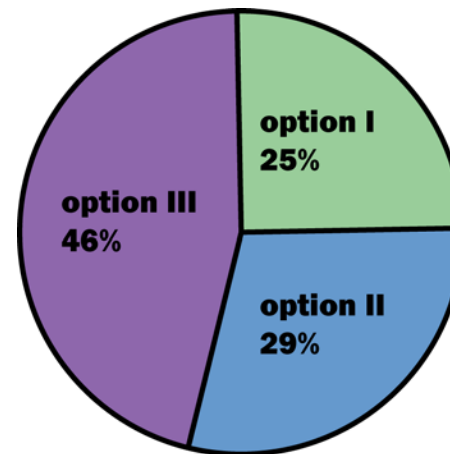

Chart 1: Patron preferences for Camille Park Master Plan options



OPTION I: BASE CASE/INCREASE MAINTENANCE

Increase maintenance and basic site improvements (ADA access, etc) per survey/public meeting comments. Progress with existing stream enhancement and kiosk-installation plans; establish loop trail/site circulation.

- a. maintain existing parking/access
- b. maintain existing tennis courts and lawn area surrounds
- c. establish a loop pathway
- d. lawn/active space
- e. maintain existing picnic/horseshoe facilities
- f. maintain/update accessibility of existing picnic area
- g. maintain/update accessibility of existing play area
- h. maintain/improve delineation and signage of existing camas preserve

OPTION I SIGNAGE:

Maintain existing camas protection signage.

- 1. Install proposed natural resources kiosk educating about stream, camas and oak ecologies.





OPTION II: MODERATE NATURAL RESOURCE-FOCUSED IMPROVEMENTS

Increase maintenance and basic site improvements (ADA access, etc) per survey/public meeting comments. Establish a meadow landscape and continue to foster the existing camas preserve; integrate a loop trail to bring visitors closer to those resources. Reconfigure the play and picnic areas for lesser-environmental impact/increased educational opportunities. Introduce park wayfinding signage for greater ease of use and accessibility.

- a. maintain existing parking/access
- b. maintain existing tennis courts and lawn area surrounds
- c. establish a loop pathway – sustainable paving or materials
- d. explore the feasibility of integrating park trails with surrounding trail access
- e. lawn/active space
- f. covered picnic area
- g. update accessibility and upgrade existing picnic area
- h. update accessibility and upgrade existing play area, remove basketball courts, expand existing play area for use by a greater variety of age groups
- i. maintain/improve delineation and signage of existing camas preserve
- j. enhance meadow/wetland area

OPTION II SIGNAGE KEY:

- 1. park entry (map and general directory)
- 2. natural resource kiosk (camas and meadow explanations/definitions/graphics)
- 3. park entry (map and general directory)

(Improvements shown in green represent features that could be installed via green materials and methods and adhere to LEED guidelines.)



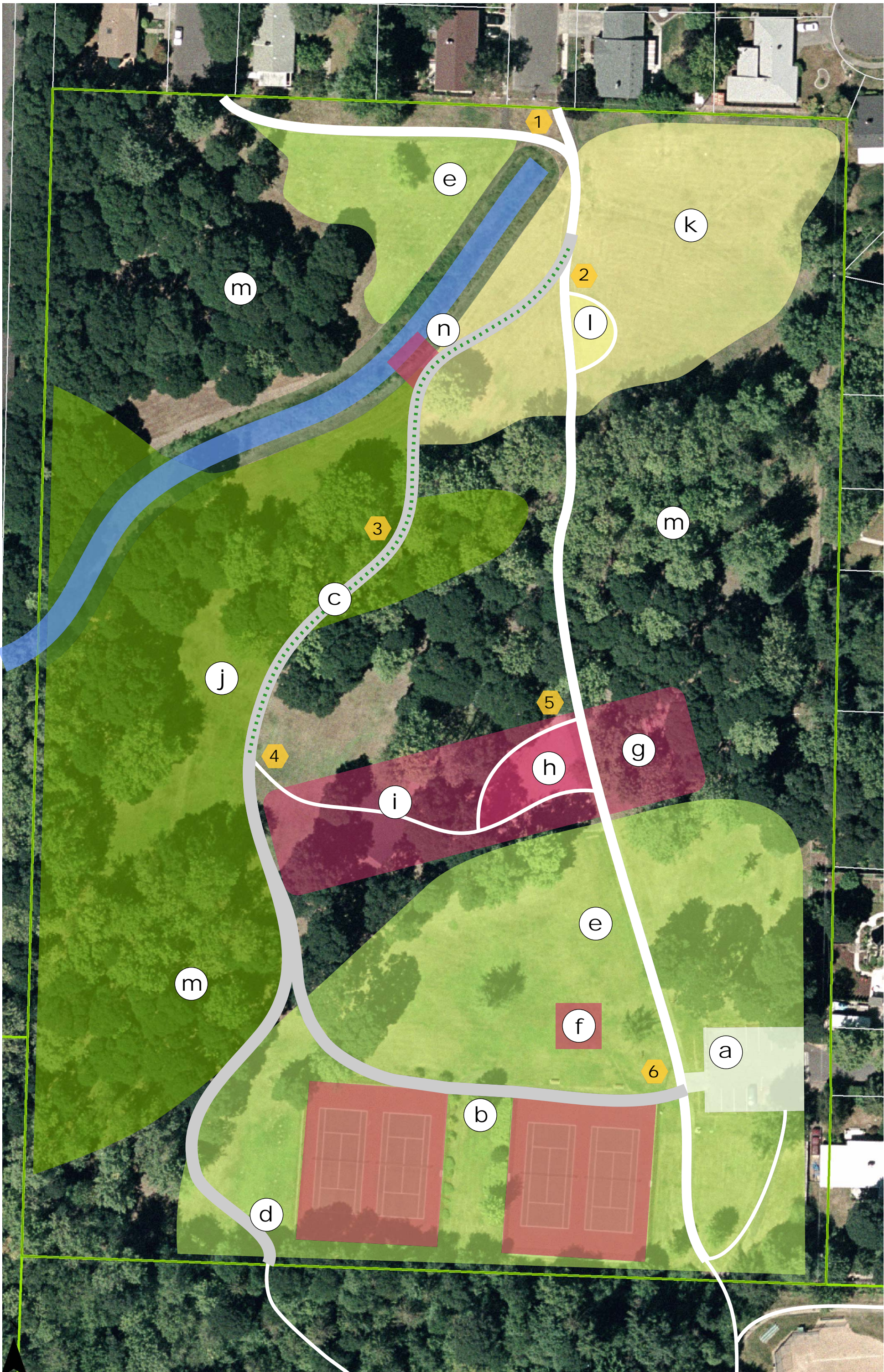

OPTION III: A NATURE PLACE

Create a nature-focused park with a strong educational component to inform park patrons about the natural resources and ecologies of the site/area. Increase maintenance and basic site improvements (ADA access, etc) per survey/public meeting comments. Establish an interactive meadow landscape; foster the existing camas preserve and Oregon oak population. Reconfigure the play and picnic areas for lesser-environmental impact/increased educational opportunities. Introduce park wayfinding and interpretive signage for greater ease of use, accessibility, and educational program. Create a loop trail with a ‘nature walk’ segment with interpretive graphics that ties into the themed playground and exploratory area.

- a. maintain existing parking/access
- b. maintain existing tennis courts and lawn area surrounds
- c. establish loop pathway – sustainable paving or materials and educational features along this segment (from meadow past camas to central area)
- d. explore the feasibility of integrating park trails with surrounding trail access
- e. lawn/active space
- f. covered picnic area
- g. update accessibility and upgrade picnic area to include sustainable materials/furnishings
- h. update accessibility and upgrade/replace existing play area with a nature-themed active space, accommodating younger children
- i. create an exploratory nature path for older children (text/education-heavy graphics)
- j. maintain/improve delineation and signage of existing camas preserve
- k. enhance meadow/wetland area
- l. create an interactive meadow landscape with a seating and interpretive area
- m. oak-enhancement area – protect existing, plant for future
- n. stream overlook with interpretive signage

OPTION III SIGNAGE KEY:

- 1. secondary park entry (map and general directory)
- 2. meadow/wetland education point
- 3. camas preserve education point
- 4. exploratory nature path start/education point
- 5. oregon oak education point
- 6. primary park entry (map and general directory)

(Improvements shown in green represent features that could be installed via green materials and methods and adhere to LEED guidelines.)

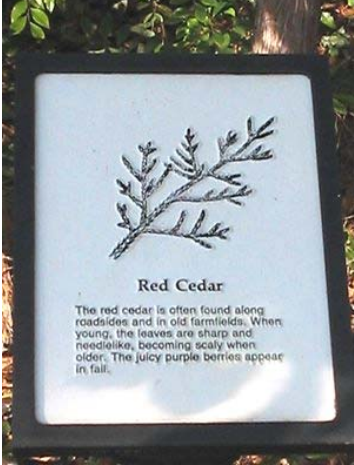

THE MASTER PLAN

OVERALL DESCRIPTION OF THE APPROVED MASTER PLAN

The approved Master Plan represents the contributions of many individuals and groups including the THPRD Board of Directors and staff, Patrons, the Denney-Whitford NAC, and other community stakeholders. Based on Patron comments, staff modified Option III to create the approved plan, which follows. This Master Plan will provide a shared vision and funding strategy for future enhancements and modifications to Camille Park.

The approved Master Plan aims to turn Camille Park into a “Nature Place” where Patrons can be immersed in the park’s natural features while enjoying the more active recreational amenities of a developed park. The plan takes advantage of the site’s natural resources by highlighting features like the Oregon white oak trees and wetlands via a loop trail. The plan locates recreational amenities in drier, less environmentally sensitive, and more accessible areas. It also calls for the removal of the basketball court to protect resources and reduce maintenance costs.

A key element of the plan is the educational aspect which will allow Patrons of all ages to gain a sense of wonder and understanding of nature through interpretive signs, interaction with the environment, and play. Proposed structural improvements to the park employ sustainable building materials. (Improvements with an asterisk represent features that could be installed via green materials or methods and adhere to LEED (US Green Building Council’s Leadership in Energy and Environmental Design) guidelines.) All new park improvements should be considered for ADA accessibility and current safety standards.

Elements of the approved Master Plan (letters correspond to locations on map on p. 17):

- a) Maintain existing parking and associated access.
- b) Maintain existing tennis courts and mowed lawn area surrounding them.
- c) Establish loop pathway.

- Use sustainable boardwalk and paving materials as well as educational features along dotted segment (from meadow past camas to central area).
- Pathway would be situated just uphill from wetland areas where possible in order to minimize impact to sensitive areas while allowing viewing access.
- d) Explore the feasibility of integrating park trails with surrounding trail access.*
 - Several informal trails lead off of Park District property onto Beaverton School District property and adjacent undeveloped private property. They are often muddy or overgrown with vegetation and strewn with trash. Park District Patrons could be better served if they were allowed official access to these trails. Access easements might include THPRD trail maintenance in exchange for access to these properties.
- e) Lawn/active space.
 - These areas would be maintained to accommodate active uses such as Frisbee and informal games.
- f) Covered picnic area & picnic area consolidation.
 - Current picnic areas would be consolidated from the current locations in the NW corner and east side of the park into one larger area. The current barbeque in the NW corner of the park would be eliminated. A portion of picnic tables would be under a permanent shelter while the rest would be on the grass. This arrangement would improve the level of service and reduce impact to natural resources, while reducing maintenance service needs.
 - Update accessibility and upgrade picnic area to include sustainable materials/furnishings.*
- g) Upgrade/replace existing play area with an accessible nature-themed active space.*
 - The new playground would incorporate naturalistic play structures and themes. It would allow children to engage in many of the same types of physical activity that they would on a traditional playground, but it would also function as an educational amenity. Elements such as a climbing web, a crawl-through “log” or nest that stimulate creative play would be part of the design. Natural



materials such as wood, rope, and living plants would be incorporated where appropriate.

- Fiberglass climbing rocks will be installed for older children, teens, and adults. Rocks will allow more challenging play and should accommodate and encourage use by multiple participants.
- h) Create an exploratory nature path for older children.
- The path will have images and tactile elements imbedded in concrete and/or via interactive signs that invite children to touch, look, and learn about nature in the park.
- i) Maintain/improve delineation and signage of existing camas preserve.
- Trail and interpretive signs will delineate the camas meadow while providing education and appropriate access.
- j) Enhance meadow/wetland area.
- This area is presently too wet to mow during much of the year and accommodates limited users during the dry season. Native shrubs and grasses could be planted here to enhance natural resource values. A buffer of mowed grass will be kept around the perimeter to keep plant material back from residences. This site may be a wetland mitigation site to make up for impacts due to trail construction in the park.
- k) Create an interactive meadow landscape with a seating and interpretive area.*
- This area would allow Patrons to contemplate nature from a seating area. It will also invite Patrons (particularly younger ones) to explore the meadow via stepping-stones, rocks, or other objects that are situated within the wetland area.
- l) Oak-enhancement areas.
- These areas would receive long-term management and planning to protect existing oaks from encroaching vegetation, limit compaction from equipment, and saplings would be installed to ensure future canopy.

(* Improvements with an asterisk represent features that could be installed via green materials and methods and adhere to LEED sustainability guidelines.)

SIGNAGE

Signs are crucial to inform visitors about park amenities and appropriate park activities. If properly written and installed, they will impart an understanding and appreciation for the parks natural heritage. The following signs are envisioned:

1. Secondary park entry (map and general directory)
2. Meadow/wetland education point
3. Camas preserve education point
4. Exploratory nature path start/education point
5. Oregon oak education point
6. Stream/watershed education point
7. Primary park entry (map and general directory)





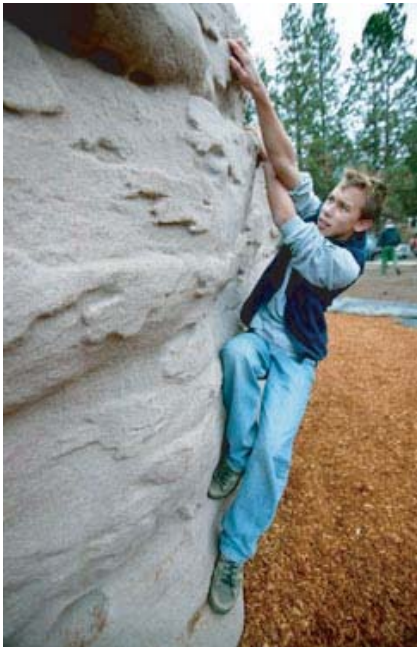

Images on this poster are examples of elements that could be constructed, once the master plan is approved and funds are acquired.



CAMILLE PARK APPROVED MASTER PLAN
TUALATIN HILLS PARK AND RECREATION DISTRICT

COST ESTIMATE

Prices reflect 2007 rates and are for the purpose of estimation only. Actual costs will depend upon exact product specification, availability, and current freight and labor costs.

Architecture & Engineering	\$40,000
Permitting	\$20,000
Site work/prep:	\$25,000
Stream bridge:	\$30,000
Pervious walking path	
Main loop:	\$75,000
Neighborhood connector segment:	\$20,000
Impervious paving (footings, picnic pad):	\$10,000
Play area (structures & surfacing)	\$90,000
Picnic shelter:	\$50,000
Interpretive/wayfinding signage:	\$16,000
Meadow planting:	\$7,000
Oak/Camas Enhancement Areas:	\$12,000
Site furnishings (rubbish bins, benches)	\$15,000
Contingency	\$97,000
Total	\$507,000



APPENDIX I

SUMMARY OF PUBLIC COMMENTS

The following documents can be found in this section:

- Camille Scoping meeting minutes 07/26/06
- Scoping survey summary.
- Plan options survey summary.
- Camille Public Meeting minutes 11/02/06

MEETING MINUTES

Camille Park Scoping Meeting – 7/26/06 (Garden Home Recreation Center, 6:30pm)

THPRD Staff: Bruce Barbarasch, April Cottini

Number of Patrons: 8

Summary

Patrons generally like the park amenities currently offered and feel the existing level of maintenance service is adequate. The group sentiment was that they did not want to see extensive development or more people from outside the neighborhood using the park. The patrons felt strongly that the tall grass is an attractive feature and that an expansion or increased level of care for the natural area was desirable. Most people who want to play ball, Frisbee, etc. do so in the drier, flatter fields on school grounds. Staff needs to consider how this park fits into the Comp Plan when making changes/future plans.

Detailed Comments

1. Picnic Area.
 - 1.1. There has been an increase in the number and frequency of people using the area in recent years. This has led to increased amounts of trash. Some visitors use the trees as a bathroom. A Monday garbage pick-up would be desirable.
 - 1.2. There was no desire for an increase in picnic facilities such as a pavilion or more tables.
2. Porta Potty
 - 2.1. Having a disabled accessible porta potty or even one near the paved area would be preferred over the one on the grass.
 - 2.2. Patrons did not want a permanent restroom structure.
3. Parking Lot
 - 3.1. Sometimes it gets quite full, but this was not a concern. (I got the feeling they preferred it that way to keep crowds down.)
 - 3.2. It is good that the basketball court is far away from parking lot to prevent nighttime activity.
4. Basketball/Tennis Courts
 - 4.1. The tennis courts are appreciated and get heavy use by neighborhood and regional users.
 - 4.2. Tennis courts are also used to ride bikes, skateboards, etc.
 - 4.3. Basketball attendance comes and goes.
 - 4.4. Basketball court is a good amenity, but sited poorly. Too wet to use/access during parts of the year.
5. Walking Path



- 5.1. People like the path.
- 5.2. A loop trail is desirable.
- 5.3. Motorized scooters are a problem.

SCOPING SURVEY COMMENTS SUMMARY: AUGUST 2006

56 surveys returned

How often do you and/or your family visit the park?	percentage total
Several times each week_____	41%
Several times a month_____	30%
A few times each year_____	24%
Very seldom or never_____	4%

Among those responding	
I visit more during the summer_____	52%
I spend time in the park year around_____	48%

What is it about Camille Park that you like the best?	weighted scores
walking path_____	105
trees_____	105
play structure_____	42
mowed grass_____	31
tennis courts_____	19
camas flowers_____	9
creek_____	3
solitude_____	2
open space_____	1
picnic area_____	1
proximity to house_____	1

Are you happy with the level of maintenance in the park?	percentage total
yes_____	81%
no_____	20%
abstain_____	2%
yes/no_____	2%

Did you know that Camille Park has a Camas lily preservation area?

yes _____ 60%
no _____ 40%

How valuable is Camille Park as a natural resource area?

high _____ 69%
medium _____ 20%
low _____ 4%
unsure _____ 7%

Comments:

summary 1	summary 2	comment
ADA		Maintenance of playground, tennis courts, walking path, and fields in general are very well done. Would like to see more areas accessible by foot or physically disabled people.
amenity		improve horseshoe pits.
amenity	path	It would be nice to have a tennis "wall" for solo tennis. A covered area (reservable?) would make the park a good destination for small picnics and get-togethers. I don't know if the forest-y area between the park and Whitford School is part of the park, but having some clearly defined trails through that area (rather than the narrow ones there now) would make for a nice, short hike.
amenity	dogs off leash	Skate park near the tennis courts. Insist that dogs be on a leash - don't allow it to become a dog park
bathroom		Better bathroom facilities. People using bathroom behind trees is not good for children.
bathroom		Definitely need a permanent rest room facility that would be indestructible!
bathroom		rest rooms
bathroom		Need a porta-potty at least during the summer months
bathroom		The porta-potty was a big help. A restroom facility would be best. I don't know if the cost would be worth it.
citizen involvement		Attentive care and maintenance, participation & awareness of/by neighborhood and citizens.
dog off leash		Even though there are signs stating that DOGS are to be on leashes, it seems that nobody obeys this law! As a parent of two young children, it concerns me when I see dogs running around in the general area of my children. I have not seen or heard of any children getting hurt from a DOG, but I don't think that is what needs to happen before this law is reinforced!
dog off leash		In certain public areas there are metal signs stating that dogs must be on leash at all times and disobeying law may lead to a large \$\$ fine. Perhaps such signs would inspire park users to realize that Camille Park is NOT an off-leash dog park.
dog off leash		Open field areas great for exercising big dogs. Pet-loving neighborhood. Off-leash fencing? NE corner?
greenspace	neighborhood	A local green space for families, within walking distance, in their neighborhood. As I am now a senior I do not use the park as much.



greenspace	natural area	Mostly simply the green space, the trees, grass and the stream.
greenspace	amenity	The open space, tennis courts and play structure draw families which should be encouraged.
greenspace	stream	The open space. I wonder if all the trees are healthy (?) Also, something more needs to be done with the waterway running through it
greenspace		The preservation of undeveloped-un'improved' space
increase maintenance		(The blackberry bush) gets worse every year. Appreciate this end of park kept mowed.
increase maintenance	dogs off leash	Better maintenance of the grassy areas, (mowed more often), graffiti removed from the play structures, better vigilance regarding dogs that are supposed to be on-leash (perhaps a designated area away from the play structures and path for off-leash dogs)
increase maintenance		Blackberry vines have taken over lovely bush at NE corner of park (next to my front yard) I would like to see something done to control this problem.
increase maintenance		It seems that many times we're at the park, the water fountain does not work. The park is usually clean, there seems to be no evidence (and I hope it stays that way) of nighttime activity (drugs, condoms) that I've seen at other parks. Although there has been some recent foul language scrawled on the play structure!
increase maintenance		Please keep up the maintenance.
increase maintenance		Please cut blackberry bushes invading our yard and keep trash picked up.
misc.		I don't really understand what is meant by natural resource area. Does that mean 1) nature availability? 2) provides natural resources?? The term is a little vague.
misc.		I leave that to those who are in charge of the parks.
misc.		Installation of drainage tile throughout park.
misc.		Keep it maintained and a safe environment for children and families.
misc.		Keep up general maintenance
misc.		Keep up the good work!
misc.		Permanent covered drainage pipeline through swale
misc.		The park doesn't have flowers
misc.		We love our park - raised 4 children and 10 grandchildren in our park -
misc.		continued maintenance
mowing		Cleanup under trees where no grass is growing - there is a lot of debris. Park is mowed in patches instead of all at once.
mowing		Keep doing what you've been doing but maybe do a better job of mowing and raking up the grass.
mowing	stream	Mowing grass around path; ongoing crack maintenance
mowing		Please mow grassy meadow cut in summer. We do not want it to go natural- it would be a fire hazard. We live on park at end- next to grassy meadow- we were at the meeting at Garden Home. We talked with other neighbors on the park- we want the grass mowed- fire hazard! People do smoke in the park and could start a grass fire.



mowing		Slow on grass cutting- need to start earlier
natural area		Green space with trees, ecology all year, ducks in the winter and spring, frogs and newts, snakes, birds
natural area	path	Having more native plants to enhance the forest effect of the park. Have walking path meander through the area so as to enjoy the natural beauty. The path doesn't have to be paved, the more natural materials the better. Place benches throughout the park especially near the play structure.
natural area		I just love seeing the birds and squirrels and other wildlife come through there so I would love to keep it that way
natural area		It's a place where animals live, if we take it away where do they go?
natural area		It's beauty, availability for immediate neighborhood enjoyment and animal habitat is most important to us.
natural area		Keep it as it is. It makes for some great wildlife walks. The area is a wetland and many ducks nest here.
natural area		more flowers
natural area	path	Some areas do not need to be mowed, leave them natural.
natural area	trees	Natural Green Space, Trees, stream and Camas.
natural area		Nature paths in forested area on 217-side of park
natural area	solitude	Preserving the solitude/tranquility of the park. Return park to a more natural state - remove picnic area/playground/basketball court. Before these structures were put in, we had deer, pheasants and lots of ducks. Plant native trees/shrubs in wide-open spaces.
natural area		Preserving the Oak trees and Camas through prevention of ground compaction, i.e. mowers and ped traffic during the wet months
natural area		Retain the natural look of the area
natural area		The marsh/wetland aspects of Camille Park bring with it a great potential for plant & animal life, and I would like to see this capitalized on. I think a deliberate preservation of the wetlands and enhancement of wildlife resources (how about bat boxes?)
natural area		Vegetation, oxygen production, unpaved surface to absorb water, creek and woods for wildlife.
natural area	path	We love the resource this park gives us, not only for exercise, but also a learning science lab; it would be nice to have a walking path much like the one the boy scouts started but have it complete a circle. Our neighbors have impromptu picnics late spring and all throughout the summer and we are also on our 2nd annual Easter egg hunt. In the winter we have plenty to explore as well.
natural area		wetlands - don't drain them
natural area		Waterway, camas lily, trees. I don't know but would happily be involved as a volunteer if I could be useful. I have some concerns about the use of vegetation killers around the trees. I had wonder why there are never any of the customary mushrooms that usual present under oak trees, but now I know.
natural area/education	playground	Again using native plants and turning it into a wetland. Attract birds and animals. Also, I would like to see the play structure reflect more of the environment. Make it different from the structure at McKay School. Have signs that teach about the Camas lily and any other plant life.
natural area/education		Any saved resource is valued - because of this park location to school it is a great teaching resource.



natural area/education		As density in Beaverton increases, these little oases become increasingly important both for humans and for wild life. Don't make it too "civilized" as we need natural spots.
natural area/education		Capitalize on the wetlands angle of the park, plan safe walking routes that will allow us to view the wildlife without disturbing it, and work with Shurguard to do something along the back edge of the park (they have mentioned making themselves available in the past).
natural area/education		Natural areas for wildlife and children to explore natural settings
natural area/education		Now that I know there's a Camas preservation area, I think we should keep that. (And maybe add some signs pointing people to it?)
natural area/education		The marsh area provides nesting areas for Red Wing Blackbirds and waterfowl. It gives the kids a vision of what the area around here used to be.
neighborhood		By keeping it our neighborhood secret.
neighborhood	no changes	I would hope that Camille park will keep its "neighborhood" park feel. Absolutely would not support any future activity built at north end. I've already dealt with broken windows from stray balls.
neighborhood		Keep the park as a neighborhood park, since limited parking will not support added activities.
no changes		Leave as it is, Camille park serves the varied needs of a large community. Very little change is necessary.
no changes	scooter problems	Do not add any more paths, especially around perimeter of park. We already have problems with kids riding motorized bikes/scooters on the existing path.
no changes	natural area	Do not make "city improvements" leave it in a natural state!
no changes		Keeping much as is today.
no changes		Leave it alone until people become a problem to it.
no changes	neighborhood	Leave it as it is. You improve it and more people will use it and the neighborhood will see more crime and loud parties.
no changes		left alone
no changes		Spend NO money on it, you have spent enough.
no changes	natural area	This city puts too much emphasis on building and so-called "improvements" on natural spaces - leave the natural spaces alone and force living in what's already here - and built. There are too many EMPTY homes/apts etc and not enough open space!
no changes		Do not spend any money on anything, you spend too much as it is.
path	ADA	I was able to walk to the park frequently but need to check its accessibility for wheel chair use now. I will be happy to share with you how easy the path is for my wheelchair.
path		Just make sure that the walking paths remain above water in winter.
path		No complaints so far—keep doing what you're doing. I would like to see the walking path extended through the park so that a walker or runner could run a loop of some sort. As a person with allergies, walking on a paved path is better than walking through the grass, especially in spring and summer.
path	tree maintenance	Recent path repair is good. Falling twigs and branches frequently litter the paths and a hazard to older people.



path		The park is fine where the playground is but the trails and walking paths could be better kept up
path	natural area	The walking path to enjoy the camas flowers
path	natural area	There are some trails in the forest that have grown over, if we cleared them there would be more trails to walk on and maybe more people would enjoy it more if there were more paths.
path		Walk path around perimeter would be nice.
playground		Expansion of the play structure area. A lot more children come than from just the neighborhood. More garbage cans.
playground		I never actually see park maintenance there, even though I'm sure there are people on the job. I feel a bit like it's the forgotten park. There are many families in the area who make use of the park, and I would really like to see a better, more expanded play area for smaller children.
playground		I think that you could have a play structure for older kids as well as younger.
playground	increase maintenance	Improve playground equipments for safety reasons. Would like park kept as it is with regular mowing and maintenance.
playground		Really keep the play structures up. maintain them, make sure they are in good repair, etc.
playground		That the play structures are inspected for any breakage or damage and maintained/cleaned on a regular basis.
playground		Try to get rid of muddy areas around playground. Work with the grading to prevent falling around playground.
restoration		Avoid compaction and begin growing a replacement crop of trees. The lack of native forbs and middle story is appalling.
restoration		fewer open spaces and more trees
solitude	neighborhood	The peace and quiet and beauty should be kept as maintained as possible and kept as a small neighborhood secret.
stream/natural area		Build the stream to meander through the park with walkway along the side - use stream for water retention; park is very 'marshy' in the spring
stream/natural area		Concerned about natural resource of creek because of litter - lots of kids play in it; can best be managed by educating neighborhood.
stream/natural area		make creek into a feature element
stream/natural area		Make creek more into a feature - make more paved paths for jogging and walking
stream/natural area	path	Use stream for water retention and as a feature meandering through the park; have walkway along side for jogging and walking
too big to summarize		A loop trail around the park would enhance year round walking in the park. Adding forbs and middle story patches to the Oak forest would create more habitat and things to experience while walking. Additional benches in the play area and loop path would provide resting/viewing places. The addition of a small skate spot feature for teens would make the park more usable to a wider demographic. Updating the very old school play equipment to provide some spinning and interactive play from tots to teens is critical. Safety and ADA requirements need to be satisfied. For instance accessible benches & basketball court. Swing set clear zones are clearly not being met!! The porta potty isn't even ADA accessible located in the grass. Finally, the NE corner of the park is currently wet 90% of the year. Why can't area be replanted to a wet meadow? It seems like a waste of effort to keep this in non-native turf. A meadow of native plants would greatly improve the habitat and provide an interpretive opportunity for park visitors.
trail	mowing	Keeping mowing grass in grassy meadow to maintain a walking path.
tree maintenance		As previously stated, more tree maintenance.



tree maintenance		Current maintenance good but several large trees have dead branches and some appear to lean dangerously. More tree maintenance would be appreciated.
tree maintenance		I would like to see fallen branches removed relatively soon after they appear.
tree maintenance		In general I like the maintenance of the park. It would be nice if the dead branches that fall on the ground be removed more than once/year.
tree maintenance		Making sure the huge branches that fall, get picked up. Or maintained before they fall.
tree maintenance	bathroom	Some trees need trimming, lower branches. Park users sometimes pile debris under trees, and area is then used as a bathroom stop.
tree maintenance		The treed area. I think storm clean-up would be the best way - whenever there is a rain/wind storm, there are fallen branches and debris that don't get cleaned up in a timely manner. I think it's dangerous.
tree maintenance		The unique feature of the park is the number of trees. Maintain the trees by trimming and removing dead branches. Providing open space at the base of the pine trees (people have used these areas as outdoor toilet since they are concealed spaces).
tree maintenance		We need dead limbs trimmed - NOW. It is dangerous!!!! And the dead trees (ash) cut down east of the play equipment
tree maintenance	increase maintenance	I do sometimes have concerns about dead branches hanging over heavily frequented areas, which could land on someone in a wind. Yesterday's addition (7/7) of trashcans was appreciated. People seem to be pretty conscientious about cleaning up after themselves but its hard to when the cans are overflowing. I don't mind picking up litter as I walk though but do not want to carry it home.
tree maintenance?		Proper pruning and fertilizer
trees	path	More trees, expand path ways
trees	natural area	Plant more trees and native plants
trees		Replace older trees as necessary
trees	natural area	The trees (and the wildlife they support) plus the wetlands are important aspects of our environment.
trees	neighborhood	Trees and grassy area. Make sure sick trees are taken out and replacements placed back in the park. Nice quiet neighborhood park tucked away... its great!
trees	natural area	trees and natural state
trees	no changes	Trees and plants. Leave the park as it is and try not to build too close to it.
trees		Keep trees healthy- plant new trees as needed



SUMMARY OF PUBLIC COMMENTS ON THREE OPTIONS : NOVEMBER 2006

28 votes collected

<u>preferred option</u>	<u>number of patron votes</u>	<u>percentage</u>
option I	7	25%
option II	8	29%
option III	13	46%

Comments:

Playground

- playground needs usual play equipment with additional upgraded nature-themed pieces
- better nature area & playground equipment - not industrial child equipment;
- Any changes are welcome - but please leave some playground equipment.
- Play area seems lovely as is

Sports courts

- I think [the] basketball court should be kept in the plan.
- Tennis courts and playground should remain.
- volleyball net near tennis courts with added path as needed; possibly where 'd' is could be developed and a covered picnic area.
- I would leave the basketball courts.
- We have 2 schools within walking distance with fields for playing ball games etc. Small areas for picnicking and playing are fine, but I don't want to see large areas eaten up for that.
- I hope that the basketball court will stay...there are many older kids that play basketball at the park...by keeping the basketball court you are meeting the needs of kids of all ages....including adults who like to play on the basketball court with their kids....a park should accommodate kids of all ages not just the little kids.
- The basketball courts are rarely used and in need of maintenance. Removing them appeals to me.
- I vote for the basketball court to stay
- would be nice to still have basketball –

Trails

- I would like to see the loop trail pushed closer to the perimeter of the park, perhaps ??? a bit above the waterline with an asphalt surface and culvert drainage.
- Loop path as planned is a good idea #c option III, if year-round useable
- I like the added loop.
- I would like to see one of the trails cross the drainage ditch and connect to area m. Generally lengthen loop trail.
- and please limit expansion of park trails. It has a safe feeling now.



Picnic Areas

- get rid of the picnic area and playground.
- If not, move picnic/playground away from neighbors.
- covered picnic area where basketball court is now.
- needs covered table area

Natural Areas

- Make park a total natural resource so it will attract more wildlife.
- KEEP CAMILLE PARK NATURAL!
- I am in favor of improving Camille Park to be a more natural park. Certainly, I don't want to any tress cut down, and we need to preserve the open areas as well for the animals that already live there.
- Make the entire north end a wetland protected area instead of one side being a lawn play area. Not to include the treed area. I would vote to keep that intact and the horseshoe area is fine to stay.
- option 3 has the interpretive added sections - some of that added would be great

Misc.

- add fenced area for off-leash dog park
- How about a dog park in the eastern part of Beaverton?
- it looks like teens and active uses are getting the short end of the stick, I think it's important to do some outreach for skating and BMX. Could be integrated in "d" area as a small feature. Basketball, climbing boulder, or skate spot are key.
- Stop spending so much money.
- Please keep the amount of shade that there is now.
- the more natural the better. Overdevelopment is a distinct possibility.
- Creating an open lawn, play space at the north end of the park
- if option #j area is left - don't just leave it un-mowed, plant it with plants so it's a theme. Loop path as planned is a good idea #c option III, if year-round useable; covered picnic area where basketball court is now.
- I would like to see the improvement of the creek and really that's about it. If changes have to be made, just think of all age groups, not just little kids and their playground equipment.
- I had been serious considering proposing a disc golf course for this property.
- more rock walls! (climbing boulder)
- leave it as natural as possible.
- would want to make sure water was still accessible - faucet or fountain - we walk here and play - replenishing (?) water would be great
- adding a bathroom would be great



MEETING MINUTES

Camille Park Scoping Meeting – 11/2/06 (Garden Home Rec. Center, 6:30pm)

THPRD Staff: Bruce Barbarasch, Julie Reilly

Number of Patrons: 3

Summary

Patrons were supportive of the proposed plan. No significant changes were suggested. One neighbor felt strongly that we should share the plan and publicize it to get further support and future funding.

Detailed Comments

1. Enhanced Meadow/Wetland Area.
 - 1.2 Patrons liked the meadow. A suggestion was made to plant/maintain a buffer around it that would allow tall grasses to remain in the center, but would prevent a fire (should it occur) from spreading to nearby residences.
2. Play Equipment.
 - 2.1 One patron really liked the nature themed equipment and felt that the uniqueness of this feature should be promoted in the written master plan document.
 - 2.2 Another patron felt the example of the play equipment was gaudy. She had a difficult time describing what would look better, but thought something made entirely of wood might be an improvement.
3. Misc.
 - 3.1 A suggestion was made to post the preferred option and the next steps towards approval on our website.

APPENDIX 2

Camille Park Maintenance Management Plan Summary

The intention of the Maintenance Management Plan (MMP) is to provide vision and guidelines for maintaining and improving the ecological health of Camille Park in the short and long term. Although the plan will change over time, the goal is to quantify natural resource needs spatially, temporally, and economically.

Camille Park is a heavily used and highly managed site, containing a variety of recreational amenities situated among a significant grove of Oregon white oak trees. Much of the site is wetland, and includes a camas lily preserve. Natural Resource management proposals for the park include changes to the mowing regime and irrigation schedule. A riparian buffer of trees and shrubs will be maintained along both sides of the small creek. New pathways will preserve the camas lilies and wetlands while allowing patrons to easily pass through these resources. Oak tree preservation and restoration is an important aspect of the MMP along with control of non-native weeds. Maintenance schedules and lists of key management activities for each identified habitat unit are discussed in terms of natural resource concerns.

The Camille MMP will be reviewed every three years for necessary modifications.